

APPLICATION

Metal prints are the perfect medium for displaying artwork, photography and signage in a variety of commercial applications.

Metal prints are lightweight, durable, made with recycled material and 100% recyclable. Because images are infused directly into specially coated aluminum, metal prints offer unsurpassed color vibrancy, exceptional detail, color resolution and print permanence.

ALUMINUM 030 SPECS

Sheet Size: 48" x 96" (1219,2x2438,4mm)
 Thickness: .030" (.76mm)
 Sheet Weight: 13 lbs.

- » Available in gloss white
- » Available in full sheets
- » Corners available in 1/8" radius or square cut
- » Hoffman Scratch Tester result of 1800

FEATURES & BENEFITS

- » Vibrant image reproduction
- » Exception detail and color resolution
- » 3D depth of image
- » Fade resistant
- » Will not yellow with age
- » Stain resistant
- » Scratch and abrasion resistant
- » Chemical resistant
 - » Can be cleaned with ammonia, bleach, acetone, rubbing alcohol, glass and all-purpose cleaners.
- » Moisture resistant

FIRE CLASSIFICATION:

Flame and Smoke: Class "B" Fire Rated – tested in accordance with ASTM-E84 tunnel test
 Flame: 75
 Smoke: 450 or less
 Passes: ASTM-E84-15

The National Fire Protection Association Life Safety Code 101, has a means of classifying materials with respect to Flame Spread and Smoke Developed when tested in accordance with NFPA 255, "Method of Test of Surface Burning Characteristics of Building Materials", (ASTM E-84)

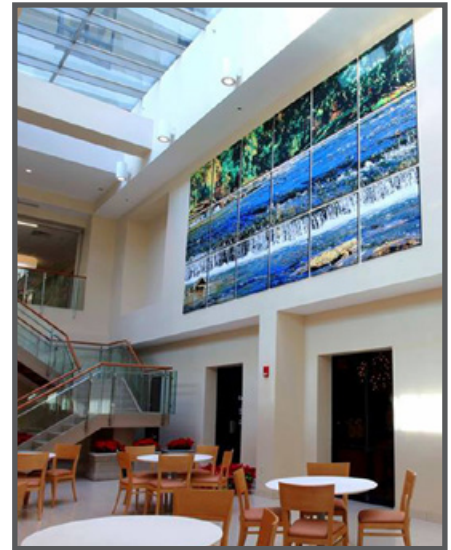

- Art Exhibits**
- Wall Coverings**
- Hospitality**
- Restaurants**
- Museum**
- Display/POP**
- Gallery Prints**
- Signage**

